

press release 05/2025

Zentrum Biffig, Schötz

Housing, nursing and healthcare under one roof

Romanshorn, May 2025. Zentrum Biffig in Schötz is a modern residential and nursing facility that offers older people a wide range of care options. In addition to 60 nursing places and 14 retirement apartments, the centre bundles various inpatient and outpatient healthcare services under one roof. Designed by MMJS Jauch-Stolz Architekten, the new building combines bright, inviting rooms with clear functionality. An open room concept and sophisticated interior design create a harmonious balance between homeliness and modern infrastructure. The steel profile systems from Forster used in the building meet all the necessary requirements in terms of transparency, safety and accessibility.

A centre for quality of life and a sense of community

With Zentrum Biffig, the municipality of Schötz in the canton of Lucerne is responding to the demographically driven increase in demand for integrated care and support services for the elderly. Designed by MMJS Jauch-Stolz Architekten, the result is a modern residential and nursing facility that combines contemporary functionality with a welcoming ambience. At the heart of the building is a central atrium on the ground floor, which acts as a kind of village square. It promotes encounters and exchanges between the residents while also providing space for cultural events. On the upper floors, the nursing rooms and retirement apartments face outwards to the front, so that access is made via the corridors facing the inner courtyard. These are designed in such a way that they lead around the building in a closed circuit instead of leading to dead ends – this solution allows residents with dementia in particular to find their way around safely and intuitively.

Openness and transparency

A large glass facade measuring 230 square metres faces the inner courtyard. It supports orientation within the building, provides visual connections to the other floors and creates a bright, inviting atmosphere throughout the building. The glazing and closures with profile systems from Forster play a decisive role here: Thanks to the narrow face widths of just 45 millimetres, the mullion/transom constructions with forster thermfix vario EI60 allow daylight to penetrate deep into the building on all floors. This is all without compromising on robustness and fall protection with the glass panels weighing over 240 kilograms. With a sound insulation factor of Rw 48 decibels, the glazing combined with the installed fire resistant doors with forster fuego light EI30/EI60 (45/47 dB) significantly reduces disturbances between the corridors, common areas and residents' rooms. Last but not least, the robust profile systems made from 100% steel contribute to the desired calm atmosphere and well-being of the residents.

Barrier-free fire protection

At Zentrum Biffig, the safety and protection of residents are paramount. Fire protection was

therefore implemented consistently with the forster fuego light profile system: Single-leaf and double-leaf fire resistant doors as well as fixed glazing with certified protection classes EI30 and EI60 guarantee the required fire safety in central areas as well as the closures of the stairwells and common areas. The restaurant on the ground floor is also equipped with an automatic fire protection sliding door with forster fuego light EI30, which also ensures barrier-free access for people with limited mobility.

A role model for modern living in old age

With Zentrum Biffig, the municipality of Schötz has created a pioneering model for age-appropriate housing that combines social integration and modern construction in an exemplary way. The new building replaces the former Mauritiusheim nursing home at the same location and shows how well-thought-out architecture, high-quality materials and technical precision merge into a harmonious overall concept. The use of profile systems from Forster underscores the project's ambition to implement sophisticated design and functional requirements down to the last detail in such a way that quality of life, safety and a sense of community are promoted.

Project information

| | |
|---------------------|---|
| Products: | Mullion/transom facade in atrium with forster thermfix vario Forster fuego light EI30 sliding door Single-leaf and double-leaf fire resistant doors with forster fuego light EI30/60 Forster fuego light EI30/60 fixed glazing |
| Architecture: | MMJS Jauch-Stolz Architekten AG, Lucerne, Switzerland |
| Metal construction: | Huber Kontech AG, Buttisholz, Switzerland |
| Client: | Biffig AG, Schötz, Switzerland |
| Photography: | © Damian Poffet |

For further information, please visit www.forstersystems.com

Forster Profile Systems – Steel is our nature.

Forster Profilsysteme AG develops and produces secure and energy-efficient solutions made from steel and stainless steel for doors, windows and facades. Forster is a partner in the property sector and offers individual advice and project support on site around the globe. The products and system solutions from Forster for the building shell and interior applications meet the most stringent requirements and standards, with heat insulation and safety features such as fire protection, burglary resistance and bullet resistance. The portfolio is rounded off by accessories and comprehensive services for customers and business partners in architecture, planning and the construction industry.

Forster works with its own subsidiaries in more than 20 countries – and exclusive sales partners in around 10 other countries from Europe and the Middle East to Asia and North America.

Press contact

Forster Profilsysteme AG
Rosina Obermayer
Marketing Communication Manager
Hofstrasse 41
8590 Romanshorn
Switzerland
T. +41 (0) 71 552 43 14
rosina.obermayer@forstersystems.com
forstersystems.com

mai public relations GmbH
Arno Heitland
Senior PR Consultant
Leuschnerdamm 13
10999 Berlin
Germany
T. +49 (0) 30 66 40 40 553
forster@maipr.com
maipr.com

Figures



The central atrium is the heart of the building and creates a bright and open meeting place – just like a village square. Photos : © Damian Poffet

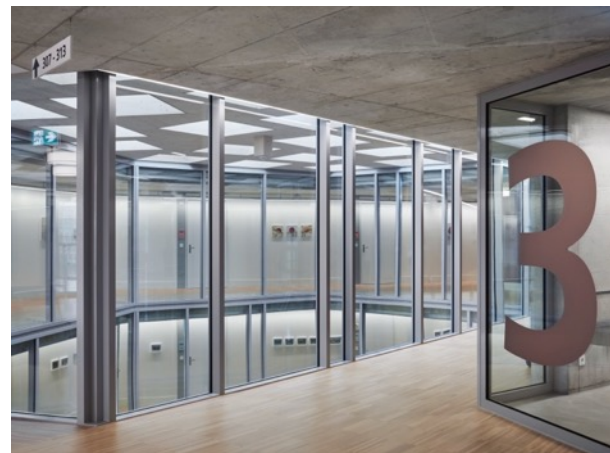

The corridors lead around the building in a closed circuit and offer residents intuitive orientation, while the generous glazing towards the atrium with forster thermfix vario EI60 ensures maximum daylight on the floors. Photos: © Damian Poffet



The restaurant on the ground floor has safe, barrier-free access thanks to the automatic fire protection sliding door with forster fuego light EI30. Photos: © Damian Poffet

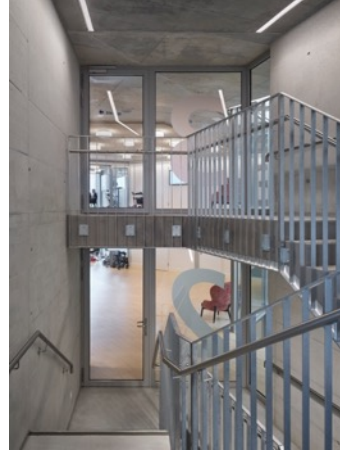

The single-leaf and double-leaf fire resistant doors with forster fuego light EI30 and EI60 offer reliable protection in the stairwell and blend harmoniously into the design concept.

Photos: © Damian Poffet

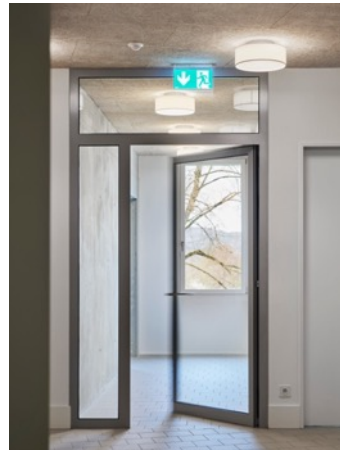

Bright common areas with generous glazing and double-leaf EI30 and EI60 fire resistant doors from the forster fuego light system create a harmonious combination of safety and transparency.

Photos: © Damian Poffet